

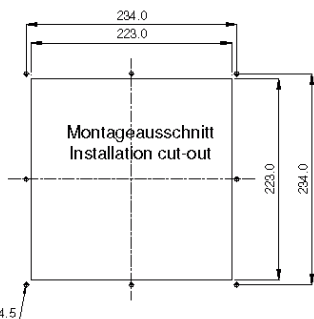

## LÜFTER/FAN GV 500 (BLASEND/BLOWING / SAUGEND/SUCKING)

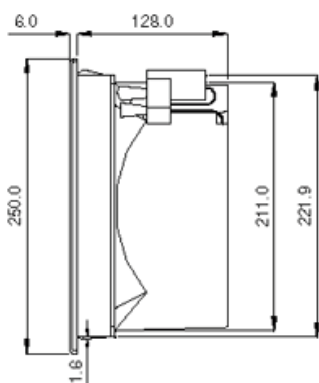
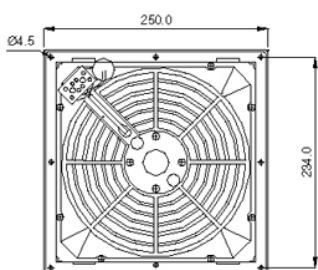

|  |  |
|--|--|
| <b>Betriebsspannung/Voltage</b>                              | 230 V, 50/60 Hz  |
| <b>Leistung/Power input</b>                                  | 50/74 W / 64/83 W  |
| <b>Stromaufnahme/Amperage</b>                                | 0,27/0,32 A / 0,34 A   |
| <b>Drehzahl/Speed</b>  | 2740/3100 min <sup>-1</sup> / 2600/2900 min <sup>-1</sup>      |
| <b>Temperaturbereich/Temp. range</b>                         | -10... + 55°C  |
| <b>Lebensdauer/Service life</b>                              | 40.000 h   |
| <b>Luftleistung (freiblasend)<br/>Air flow free air</b>      | 315 m <sup>3</sup> /h<br>incl. GF 400 K: 235 m <sup>3</sup> /h |
| <b>Schallpegel/Noise level</b>                               | 65 dB (A)  |
| <b>Farbe/Colour</b>  | RAL 7035 (Standard)  |
| <b>Schutzart/-klasse<br/>Protection type/class</b>           | IP 54, 1   |
| <b>Gewicht/Weight</b>  | 2,4 kg   |
| <b>Maße/Dimensions</b>                                       | 250 x 250 mm   |
| <b>Einbaumaß/Installation cut-out</b>                        | 223 mm   |
| <b>Einbautiefe/Installation depth</b>                        | 128 mm   |
| <b>Approbation</b>   | CE, UL   |
| <b>Passender Austrittsfilter<br/>Suitable exhaust filter</b> | GF 400K  |

| Artikel-Bez.<br>Type | Artikel-Nr.<br>Order no. | Bezeichnung<br>Description     |
|----------------------|--------------------------|--------------------------------|
| GV 500               | 100728                   | Lüfter/Fan (blasend/blowing)   |
| GV 500/SAUGEND       | 106172                   | Lüfter/Fan (saugend/sucking)   |
| GF 400K              | 100623                   | Austrittsfilter/exhaust filter |